

BEFORE YOU START

The watch winder is equipped with rotor position sensors, the rotor stops at 12 o'clock position for better watch display. When the batteries are installed or the power cable is connected, the rotor will start moving to initialize the sensor.

1) POWER SUPPLY

The watch winder can be operated by either 2 C type dry batteries or D.C adaptor. The winder operates on a safe low D.C power of 5V when mains A.C. to D.C. adaptor is used.

Using A.C to D.C Adaptor: use the adaptor supplied with your watch winder.

Unplug the adaptor when watch winder is not being used.

The adaptor should be of the following specifications:

Input Voltage: The local mains A.C. Voltage

Output: 5V D.C

Output Current: Minimum 500mA

Output Jack Type: Micro USB

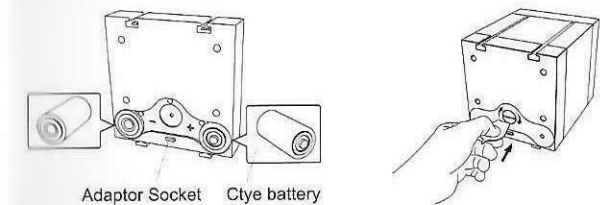

2) INSTALLING THE WATCH ON THE HOLDER AND THE CUP

Align the watch holder with the cup and insert into place. To withdraw, press the sides of the watch cushion which will release the holder from the winding compartment.

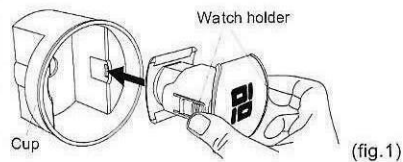

The watch holder has a spring-loaded pad at the back to allow the fitting of virtually any size watch strap leather or metal link bracelet. The soft velvet covered holder prevents damage to the watch. The watch should be set resting on the cushion and with the watch dial facing outwards as in fig 1.

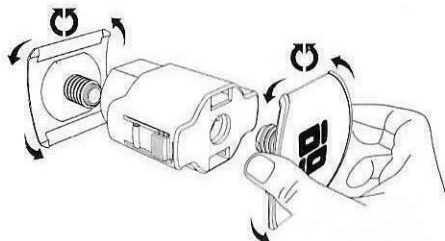

The fitting should be tight with the spring loaded pad at least half way compressed into the holder body. More compression is needed if the buckle of the bracelet is very thick.

3) CONTROLS

All functions are activated by pressing the button on the front of winder. The illuminated display shows the function number and directions.

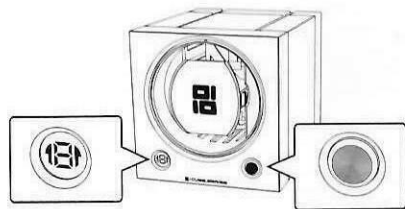

Click the button to select the function number. Each watch has a unique RPD setting; please select the closest setting for your watch.

Number	Rotation per day	Number	Rotation per day
0	Stop	5	1000
1	600	6	1100
2	700	7	1200
3	800	8	1500
4	900	9	1800

Double click the button to select the direction. These are 3 directions available: Clockwise winding, counter-clockwise winding, or bi-directional winding. Each watch has a unique directional setting; please select the appropriate setting for your watch.

Press and hold the button 3 seconds or more seconds to turn the device off. Pressing again turns the winder on.

4). LOW BATTERY WARNING

When the function number of the display flashes, the battery voltage is low. Please change the batteries or connect the winder to the power supply.

5). DISPLAY

The function number will illuminate when the input plug is plugged into the winder. If the watch winder is running by the battery, the function number will only show for 3 seconds after the setting is done to save power from the battery.

6). CONECTING WINDERS

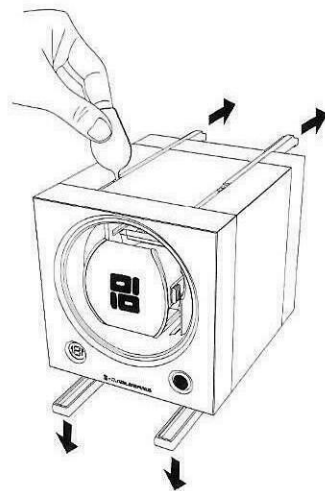

STEP1: Take out the covers from the top and bottom

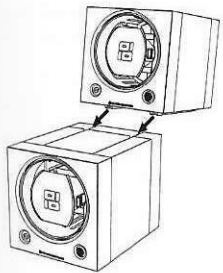

STEP2: Connecting winders

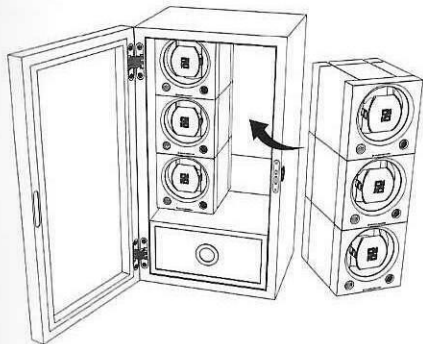

STEP3: Put winders into the casing

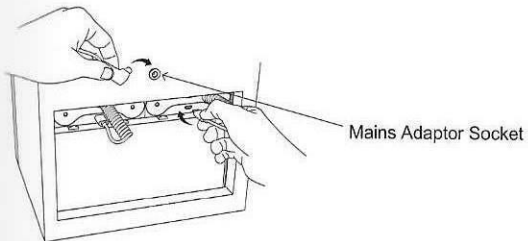

STEP4: Connecting winders to casing and

Safety Warnings

Only use the adaptor supplied with this watch winder.

ALWAYS turn off the power before inserting or taking out watches. Unplug the adaptor when the watch winder is not being used. DO NOT rotate the winder turntable at any time. DO NOT place the watch winder in direct sunlight or in environments that are either damp or dusty.

Guarantee Terms and Conditions

Guarantee validation.

This watch winder is guaranteed for 2 years from the date of purchase, against any manufacturing defect. The guarantee is only applicable on presentation of a valid proof of purchase.

The guarantee excludes the following:

Damage resulting from normal use eg. scratches, stains, marks and discoloration. Damage resulting from improper or inappropriate use of the product, such as non-respect of battery polarity, mistreatment of the case, shocks, breakage, etc. Damage resulting from use of the winder in an unsuitable environment, such as damp places, exposure to water, vibrations, sources of excessive heat, etc.

INSTRUCTION MANUAL

CUBE SERIES